



Western Silvicultural Contractors' Association

#720 – 999 West Broadway, Vancouver, BC V5Z 1K5

Telephone: (604) 736-8660 Fax: (604) 738-4080

Email: admin@wsca.ca Web: www.wsca.ca

2016 TRADESHOW BOOKING FORM

Thursday, February 4th, 2016

Coast Capri Hotel, Kelowna

Please complete and fax to (604) 738-4080 or scan and email to admin@wsca.ca.

For Publication in our Conference and Tradeshow Handout Packages:

(Please indicate if there is any information that you **do not** want the general public to have)

Company Name: _____

Contact Person: _____

Address: _____

Phone Number: _____ Toll Free Number: _____

Cell Number: _____ Fax Number: _____

Email Address: _____

Web Site: _____

Brief Description (1 or 2 sentences) about what you specialize in: _____

Number of Dinner Tickets Required (\$60 + GST each): _____ Door Prize: _____

Associate Supplier Member: Yes _____ Not Yet, But Please Invoice _____ No Thank You _____

Name Tags: _____ Name Tags: _____

Please note that up to two exhibitors are included in the Tradeshow rate. If you require more than two exhibitors at your booth, there will be an additional charge of \$45 per person.

of additional exhibitors: _____

Preferred Booth Choice Number: 1st Choice: _____ 2nd Choice: _____ 3rd Choice: _____ 4th Choice: _____

Please Check If Required

6' Skirted Table 2 Folding Chairs Evening Setup Access Electrical Access (Showtime Fee Applies)

Comments or Questions for WSCA Office: _____

PAYMENT OPTIONS

Cheque Payable To:

WSCA

#720 – 999 West Broadway

Vancouver, BC V5Z 1K5

Fax: (604) 738-4080

Credit Card: Please circle: Visa MasterCard Amex

Card Number: _____

Expiry Date: _____

Full Name on Card: _____

Signature: _____



Western Silvicultural Contractors' Association

#720 – 999 West Broadway, Vancouver, BC V5Z 1K5

Telephone: (604) 736-8660 Fax: (604) 738-4080

Email: admin@wsca.ca Web: www.wsca.ca

October 9th, 2015

Dear Supplier:

It's time once again for our *WSCA Annual Conference and Tradeshow!* For our 35th Annual Conference we will get to experience the beautiful Coast Capri Hotel located at 1171 Harvey Avenue in central Kelowna.

The Tradeshow will be a one-day component and held on **Thursday, February 4th, 2016.** Conference proceedings will take place in the Ballroom and the Tradeshow will be set up in the neighbouring Vineyard Rooms. As usual, lunch and all coffee breaks will be served in this Tradeshow area.

Your participation in the WSCA Tradeshow will enable you to make your presence and products known to the forest industry. As in previous years, we will again include our ever-popular **Passport to Prizes** draw to ensure that conference registrants visit each booth. In order to ensure success for this fun tradeshow exercise, we hope to get at least one door prize from each Tradeshow booth and Sponsor participant. Prizes can range from your company's products to corporate logo merchandise, to gift baskets and gift certificates.

To reserve your Tradeshow booth space, simply complete and fax the attached form to (604) 738-4080 or scan and email to admin@wsca.ca. Booths are reserved on a first in first reserved basis, therefore, please get your form in asap. As we have sold out in previous years, it is recommended that you reserve early to get your choice location and to avoid disappointment. Upon receipt of your booking form, an invoice will be sent to you confirming your booth designation.

All suppliers are invited to join the WSCA as Associate Supplier Members. This entitles you to all the rights and advantages of membership (except the right to vote), as well as a 20% discount on Tradeshow display space. Associate Supplier Membership dues are based at \$200 per calendar year plus GST. A membership application is enclosed, along with information about the Tradeshow and Conference Sponsorship.

If you would like to book your accommodation at the Coast Capri Hotel, special room rates are guaranteed up to Friday, January 15th, 2016; thereafter, rates and availability are on a first come basis.

We hope you can join us and look forward to seeing you in February!

Sincerely,

WESTERN SILVICULTURAL CONTRACTORS' ASSOCIATION

Syntyche Smith
Administrative Assistant

Enclosure: Tradeshow Information Sheet
Floor Plan
Tradeshow Booking Form
2016 Associate Supplier Membership Application Form



ONE-DAY TRADESHOW COMPONENT – THURSDAY, FEBRUARY 4th, 2016

INFORMATION FOR EXHIBITORS

Format

The Tradeshow will be a one-day event taking place at the Coast Capri Hotel located at 1171 Harvey Avenue in Kelowna. The display area will be set up in the Vineyard Rooms and the corridor leading to the adjacent Ballroom where the conference proceedings will take place. Lunch and all coffee breaks will be served directly in the Vineyard Rooms.

Display Units

All display units will be featured with 8' draped back walls and partitioned 3' draped walls between the booths. Each booth will be supplied with a skirted 6' table and 2 chairs. Floor space for each booth will be measured and partitioned to exactly the size indicated on the floor plan. If you require electrical access, please ensure you order this in advance with Showtime Event & Display. To make arrangements, please visit Showtime's new online ordering system for exhibitors, www.showtimedisplay.com. If you require any further information, please contact Showtime Event & Display at 1-800-721-0029 or by email at infodesk@showtimedisplay.com.

Set-up can begin anytime after 6:00 am in order to be completed in time for the arrival of participants, which will begin at 7:30 am. Alternatively, there might be a possibility of setting up the night before between 8:30pm and 10:00 pm if the room is not in use. Please inform us in advance if evening access is preferred.

Clearing of the Tradeshow Area will be from 4:00 to 5:00 pm.

Delivery Access

Due to limited storage space, the Coast Capri Hotel is unable to offer any event storage to exhibitors. For any pre or post-event storage needs, please contact Showtime Event & Display as they provide storage, shipping & receiving services to all exhibitors for events at the Coast Capri Hotel. Please note that service charges will apply, and are based on the total weight of exhibitor shipments.

Rates

The cost per booth is \$445. Associate Supplier Members (ASM) are entitled to a 20% discount (which brings the cost down to \$356). The rates include lunch and refreshments during breaks. Also, we would like to extend an invitation for you to join our contractors and speakers at our evening banquet. Dinner tickets are \$60 per person (reserved in advance, ASM discount does not apply) or \$62 per person (after January 15th), and includes a full, hot banquet buffet. All rates are subject to 5% GST.

Accommodations

Reservations for sleeping accommodations can be made directly with the Coast Capri Hotel at (250) 860-6060. Guest rooms start at \$115.00 based on single or double occupancy and include a full hot buffet breakfast served daily in the Vintner's Grill. Coast Capri also offers complimentary parking and a complimentary airport shuttle service.

To secure the special conference rates, please ensure you identify yourself as a WSCA Conference Participant and reserve by Friday, January 15th, 2016.

Breaks in Proceedings - Tentative Schedule

6:00 - 7:30 AM	Set up of Tradeshow Booths	3:00 - 3:30 PM	Tradeshow and Coffee
7:30 - 8:30 AM	Tradeshow and Registration	4:00 - 5:00 PM	Dismantling of Tradeshow Booths
10:30 - 11:00 AM	Tradeshow and Coffee	5:15 - 7:00 PM	Hospitality Suite
12:00 - 1:30 PM	Buffet Lunch and Tradeshow	7:00 - 10:00 PM	Passport to Prizes Draw & Dinner Banquet

WESTERN SILVICULTURAL CONTRACTORS' ASSOCIATION

#720 – 999 West Broadway, Vancouver, BC V5Z 1K5

Telephone: (604) 736-8660 Fax: (604) 738-4080 Email: admin@wsca.ca Web: www.wsca.ca



COAST CAPRI HOTEL

Western Silvicultural Contractors Assoc.

FEB 4, 2016

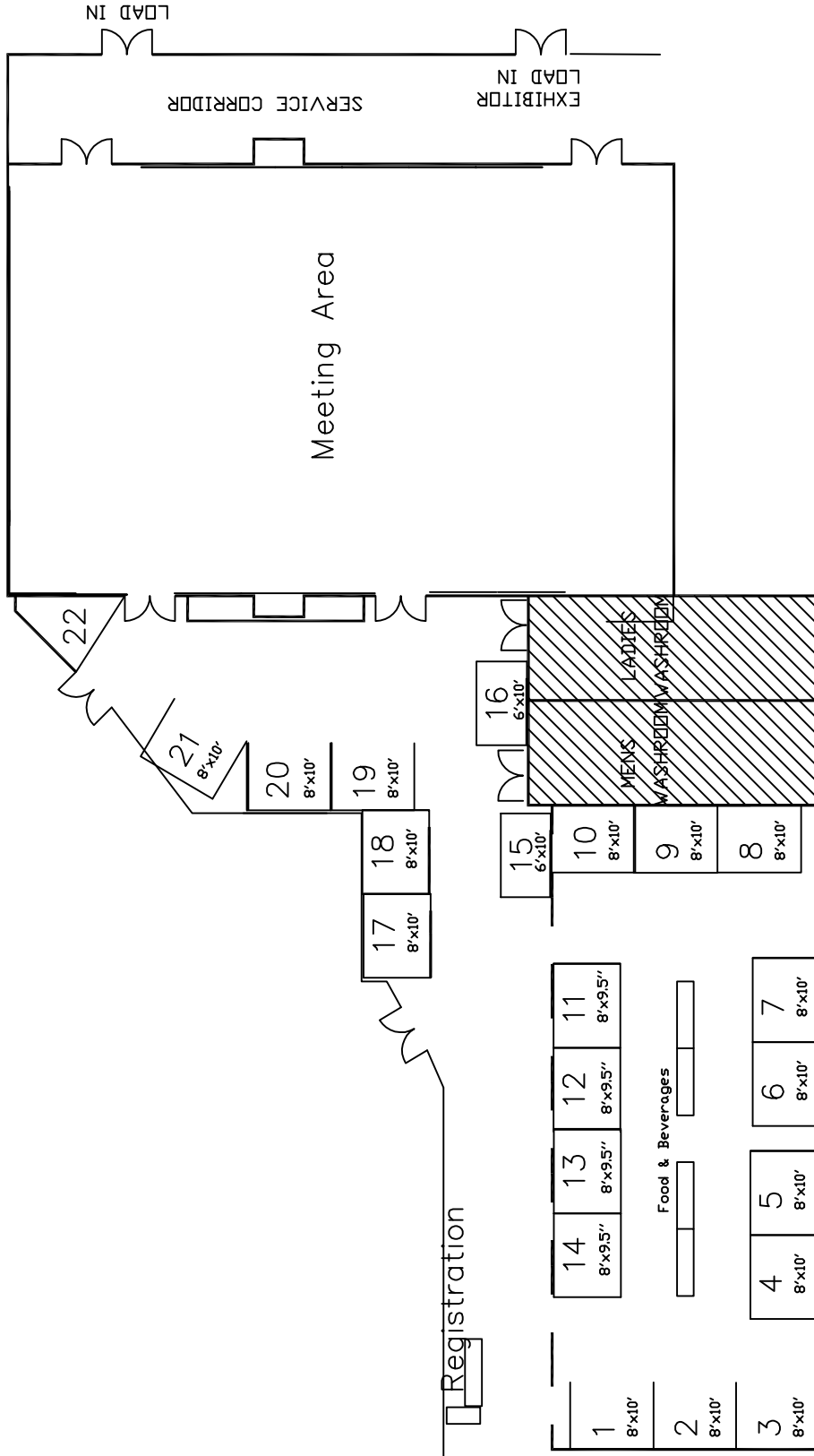

SERVICE CORRIDOR

- 16- 8x10 booths
- 4- 8x9.5' booths
- 2- 6x10' booths

Showtime Event & Display

EVENT FLOOR PLAN MUST BE APPROVED BY THE VENUE & FIRE MARSHAL
 FLOOR PLAN INPUT BY Geoff Neufeld (250) 868-2465.
 THIS DRAWING IS SOLE PROPERTY OF SHOWTIME
 THE CLIENT TO CONFIRM DRAWING SPECIFICATIONS
 PRIOR TO SETUP OF SITE
 DATE:



WESTERN SILVICULTURAL CONTRACTORS' ASSOCIATION

#720 – 999 West Broadway, Vancouver, BC V5Z 1K5

Telephone: (604) 736-8660 Fax: (604) 738-4080

Email: admin@wsca.ca Web: www.wsca.ca

Associate Supplier Membership Application

www.wsca.ca email: admin@wsca.ca

Contact Person: _____

Company: _____

Address: _____

City: _____ Postal Code: _____

Telephone: _____ Fax: _____

Website: _____ Email: _____

Geographical Location Listing: Northern Interior (ie: Prince George) Central Interior (ie: Cariboo)
 Southern Interior (ie: Kamloops / Nelson) Coastal BC Vancouver Lower Mainland Alberta

Product / Service category you wish to be listed under: *Please circle the categories on page 2 (up to a max. of 5)*

One-line description of your products or service: _____

Signature: _____

Associate Supplier Membership Dues (*includes listing as an accredited WSCA Supplier on our web site alphabetically, geographically and by product / service; also entitles you access to the Contractors Membership list, as well as a 20% discount on trade show space at our annual general meeting and conference*) \$ 200.00

Additional Advertising Options

- Web Site Hot Link** (*entitles you to the email list of all WSCA contractor members, as well as a hot link from the WSCA web page to your web page*)
 - Single Location Firm; or Annual Fee \$ 50.00 ⇒ _____
 - Multiple Locations Annual Fee # of locations ____ x \$ 50.00 ⇒ _____

- Logo Postings** (*post your logo next to company name or hot link*) Annual Fee \$ 25.00 ⇒ _____

SUB-TOTAL \$ _____

Plus 5% GST (#R127795946) \$ _____

TOTAL SUBMITTED \$ _____

Please circle the Product / Service categories that apply to your company

Suppliers Categories:

- Air Transport Services, Equipment & Supplies (Air)
- Ambulance Services, Equipment & Supplies (Ambulance)
- ATV Rentals, Sales, Service & Accessories (ATV)
- Auditing Services (Auditing)
- Browsing Control Services, Equipment & Supplies (Browsing)
- Camp Services, Equipment & Supplies (Camp)
- Carbon Offset (Carbon)
- Clothing & Footwear Services & Supplies (Clothing)
- Communications Services, Equipment & Supplies (Communications)
- Computer Systems & Software (Computer)
- Erosion Control Services, Equipment & Supplies (Erosion)
- Plantation Establishment Services, Equipment & Supplies (Establishment)
- Fire Fighting Services, Equipment & Supplies (Fire)
- First Aid Services, Equipment & Supplies (Firstaid)
- Food Services, Equipment & Supplies (Food)
- Books, Magazines & Internet Resources (Info)
- Marine Transport Services, Equipment & Supplies (Marine)
- Miscellaneous (Misc)
- Nursery Services, Equipment & Supplies (Nursery)
- Pest Management Services, Equipment & Supplies (Pest)
- Planting Services, Equipment & Supplies (Planting)
- Financial & Insurance Services (Professional)
- Pruning Services, Equipment & Supplies (Pruning)
- Safety Training, Services, Equipment & Supplies (Safety)
- Chainsaw & Brushcutter Service, Equipment & Supplies (Saw)
- Seedling & Cone Services, Equipment & Supplies (Seedcone)
- Site Preparation (Mechanical) Services, Equipment & Supplies (Siteprep)
- Silvicultural Survey Services, Equipment & Supplies (Surveys)
- Commercial Thinning Services, Equipment & Supplies (Thinning)
- Forest Worker Training (Training)
- Transport Services, Equipment & Supplies (Transport)
- Vegetation Management Services, Equipment & Supplies (Vegetation)
- Truck/van/bus Sales, Rentals & Leasing (Vehsales)
- Truck/van/bus Services, Parts & Accessories (Vehservice)